

MICROFILMED

FILED  
GREENVILLE CO S.C.  
AUG 9 2 45 PM '83  
DONNIE S. TANNERSLEY  
R.M.C.

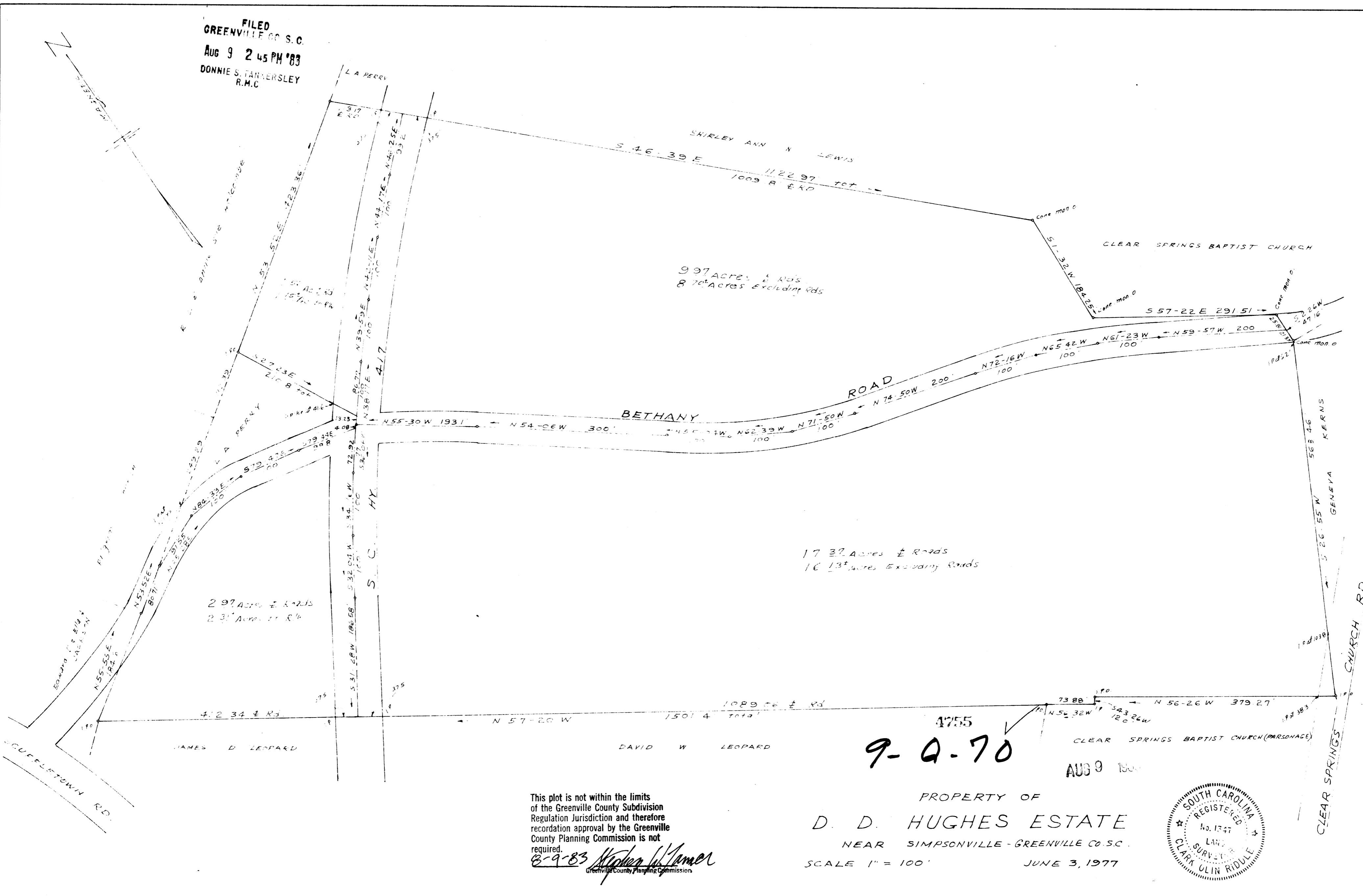

This plot is not within the limits of the Greenville County Subdivision Regulation Jurisdiction and therefore recordation approval by the Greenville County Planning Commission is not required.  
 8-9-83 *Stephen W. Hamer*  
 Greenville County Planning Commission

PROPERTY OF  
**D. D. HUGHES ESTATE**  
 NEAR SIMPSONVILLE - GREENVILLE CO. S.C.  
 SCALE 1" = 100' JUNE 3, 1977

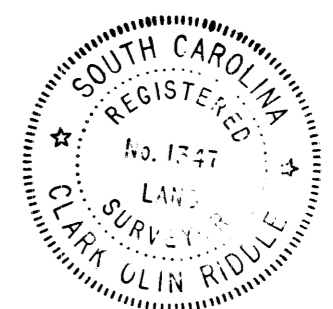

4755  
**9-9-70**

AUG 9 1983

C. O. RIDDLE - Reg. L.S. 1347 - Greenville, S.C.

F.B. 2177

4.00CI  
1.00CI

2 AU 8 83 228